

EQUIPMENT SHEET

SMIT DEE

MULTIPURPOSE WORKBOAT / PAX VESSEL



CONSTRUCTION / CLASSIFICATION

Year of construction	2003
Classification	MCA Workboat Code Cat 2

FEATURES

Compliment	18 max (6 crew)
Accommodation	Living aboard facilities for 6 crew, galley, laundry room, showers
Marine radar & Chart plotter	VHF / MF / DSC
AIS / GPS	Radio equipment
	Echo sounder
1 t Deck crane	4.7 m RIB (40 hp)
2 x 32 kW Generators (400 / 240 V 50 Hz)	

MAIN DATA

Type	Multipurpose workboat / Pax vessel
Gross tonnage	95.86 GT
Length overall	28.95 m
Beam overall	6.6 m
Max draft	1.7 m
Main engines	2 x Cummins KTA19-M4
Propulsion	2 x fixed pitch conventional with trolling capability
Auxiliary propulsion	1 x Ultrajet 305
Total power	1,305 kW
Max speed	20 kn
Endurance	At 16 knots approx. 650 NM
Air draft	12.73 m (mast lowered)

LOCATION

Plymouth

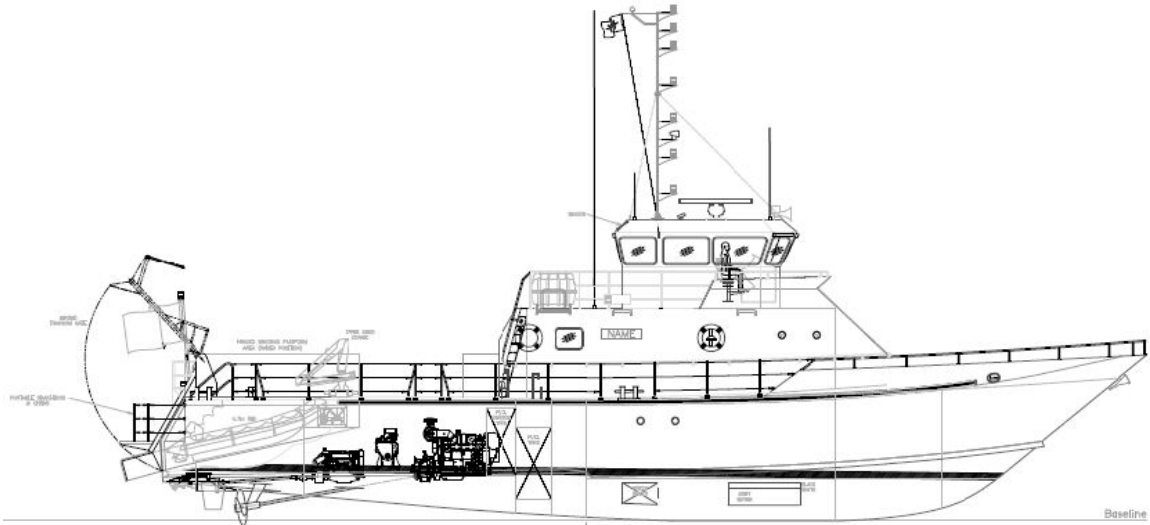

SIDE VIEW

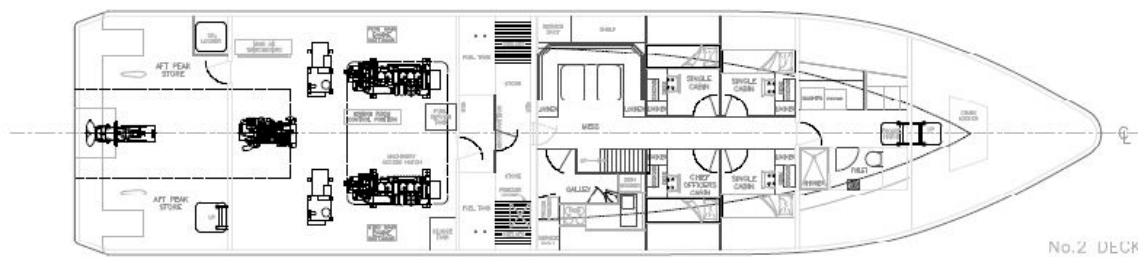
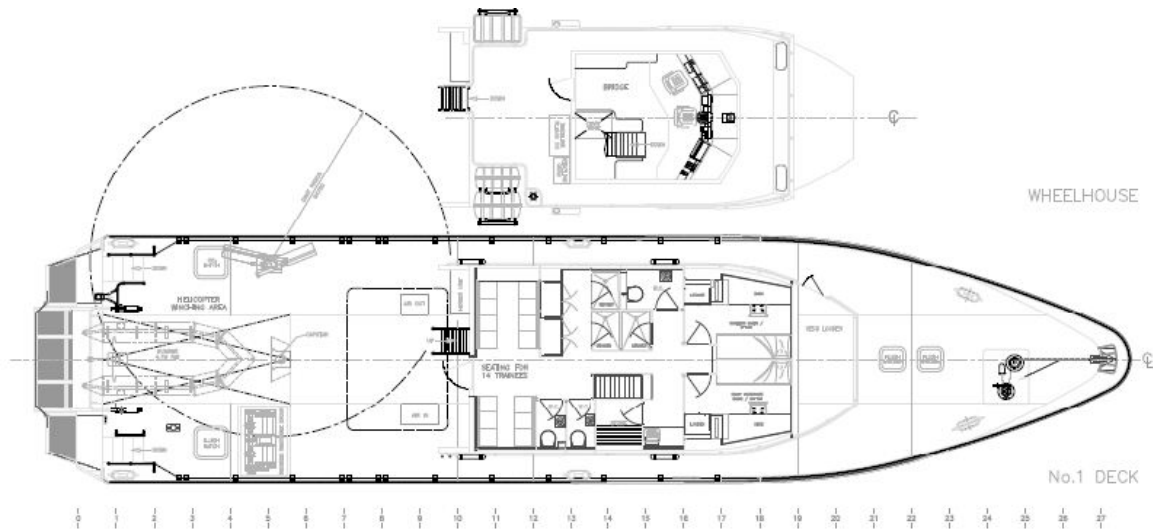

TOP VIEW

No.2 DECK
Boskalis Marine Services Ltd
 Westminster House
 4 Crompton Way
 Segensworth West
 Fareham, Hampshire
 PO15 5SS, United Kingdom
 T +44 1489 885933
 F +44 1489 578588
 bwl@boskalis.com
 www.boskalis.co.uk